

STURGES
LONDON

Waldemar Avenue, Fulham
£2,450 Per calendar month





- 2 Double Bedroom Garden Flat
- 31' Private Lawned Garden
- Reception Room | Separate Kitchen
- Bathroom | Good Storage
- Ground Floor of Converted House
- Approximately 699 sq ft [65 sq m]
- Attractive Residential Road
- Great Location for Locals Parks and Transport





Waldemar Avenue, London

A spacious and versatile 2 double bedroom garden flat located on this quiet residential road running off the Fulham Road well situated equidistantly between the Parsons Green and Bishops Park areas of Fulham.

Local Authority: London Borough of Hammersmith & Fulham

Council Tax Band: D

STURGES
LONDON

Waldemar Avenue, SW6

Approximate gross internal area
64.93 sq m / 699 sq ft

Key :
CH - Ceiling Height

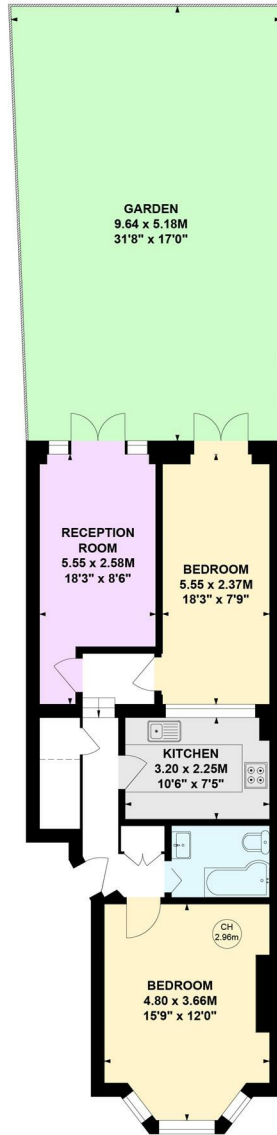

Ground Floor

This plan is not to scale and must be used as layout guidance only. All measurements and areas are approximate and should not be relied upon to provide accurate information. This plan must not be relied upon when making property valuations, design considerations or any other such relevant decisions. We accept no responsibility or liability (whether in contract, tort or otherwise) in relation to any loss whatsoever arising from or in connection with any use of this plan or the adequacy, accuracy or completeness of it or any information within it.

Energy Efficiency Rating		
	Current	Potential
<i>Very energy efficient - lower running costs</i>		
(92 plus) A		
(81-91) B		
(69-80) C		73
(55-68) D	64	
(39-54) E		
(21-38) F		
(1-20) G		
<i>Not energy efficient - higher running costs</i>		
England & Wales	EU Directive 2002/91/EC	

For more information, please contact:

(Tel) 020 3393 2002

(Email) hello@sturgeslondon.co.uk

668 Fulham Road, Parsons Green, London, SW6 5RX

sturgeslondon.co.uk

Agents Note: Whilst every care has been taken to prepare these particulars, they are for guidance purposes only. All measurements are approximate and for general guidance purposes only and whilst every care has been taken to ensure accuracy, they should not be relied upon and potential buyers/tenants are advised to recheck the measurements.